

ENCODER EC12 24 PULS MET SCHROEFDRAAD

€ 2,18

Excl. BTW: € 1,80

Afbeeldingen

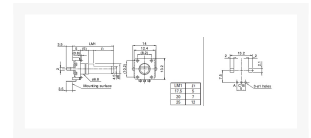

Beschrijving

Features

- Compact design
- Number of pulse: 12,15 or 24
- Mechanical angles 360°
- Optionally with push-on switch



Technical Specifications



Rating Voltage:	5V DC
Input Current	
EC12E:	0,5mA
EC12D:	1mA
Insulation Resistance (Min.)	
EC12E:	10MΩ / 50V DC

EC12D:	100MΩ / 250V DC
Dielectric Strength (1Min)	
EC12E:	50V AC
EC12D:	300V AC
Operating Torque	
EC12E_:	3 ^{±2} Nm*m
EC12D_:	10 ^{±3} Nm*m
Rotation Angle:	360°
Lifetime:	30x10 ³ Operations
Switch Specifications	
Contact	SPST-NO
EC12D_:	1mA / 5V DC
Temperature Range	
EC12E:	-10°C...+70°C
EC12D:	-40°C...+85°C



Selection Table

Part Nr.	Design	Number of Detent	Number of Pulse	Travel of Switch [mm]
EC12E1220405	plain collar	12	12	-
EC12E24204A9	plain collar	24	24	-
EC12E2420801	with bushing	24	24	-
EC12D1564402	push-on switch	30	15	0,5

Artikelnummer	12E2420801
Merk	ALPS
Is on Sale	Nee



Productinformatie