

## GESCHAKELDE VOEDING SINGLE OUTPUT 25W 13.5V/1.9A

€ 19,95

Excl. BTW: € 16,49

### Afbeeldingen

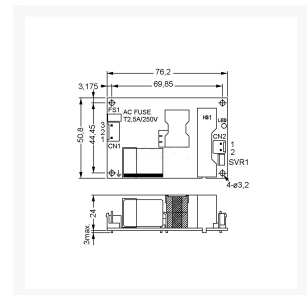

### Beschrijving

#### Features

- Open frame
- Compact case, 3" x 2"
- Contact pin for nylon-crimp terminals
- Universal input
- Overload protection, pulsing hiccup shutdown, auto recovery
- Protections: short circuit/over load/over voltage
- Low no load power consumption



#### Technical Specifications



Input Voltage:

85...264V AC (47...63Hz)

120...370V DC

Input Inrush Current, Max.:	35A
Leakage Current, Max.:	1mA
Over Load Protection:	115...170%
Withstand Voltage	
I/P-O/P:	3000V AC
I/P-FG:	2000V AC
O/P-FG:	500V AC
Operating Temperature:	-30...+70°C
Weight:	81g

I/P = Input, O/P = Output, FG = Frame Ground



Part Nr.	$U_A$	$I_A$	$P_A$	$DU_A$	$U_{RN}$	$h$
	[V]	[A]	[W]	[%]	[mV <sub>p-p</sub> ]	[%]
EPS-25-3.3	3,3	0...5,5	16,5	2	60	79
EPS-25-5	5	0...5,5	25	2	60	81
EPS-25-7.5	7,5	0...3,74	25,5	2	80	83
EPS-25-12	12	0...2,34	25,2	1	100	86
EPS-25-15	15	0...1,87	25,5	1	100	87
EPS-25-24	24	0...1,17	25,2	1	180	88
EPS-25-27	27	0...1,05	25,65	1	180	89
EPS-25-36	36	0...0,78	25,2	1	200	89
EPS-25-48	48	0...0,59	25,44	1	240	90

$U_A$  = Output Voltage,  $I_A$  = Output Current Range,  $P_A$  = Output Power,  $DU_A$  = Output Voltage Tolerance,  $U_{RN}$  = Ripple & Noise,  $h$  = Efficiency

## Productinformatie

---

Artikelnummer	EPS2513
Merk	MEANWELL

